

LONGDALE 1989

NATIONAL WETLANDS INVENTORY
UNITED STATES DEPARTMENT OF THE INTERIOR

LONGDALE, OKLA.

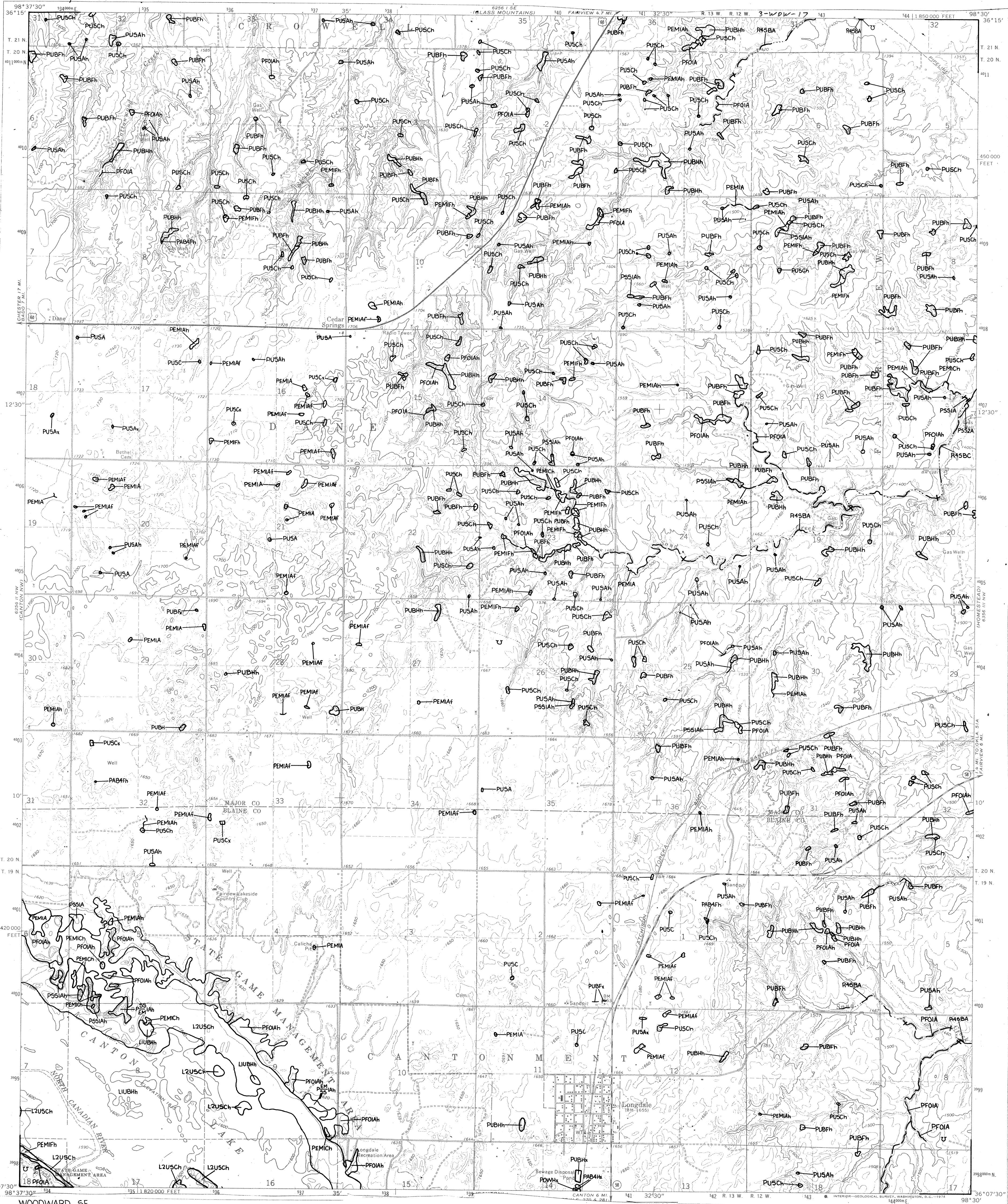

WOODWARD SE
FAIRVIEW

LONGDALE, OKLA.

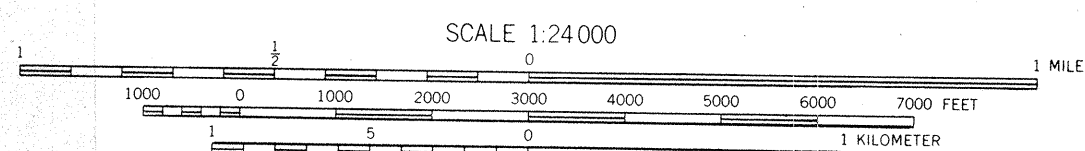

☐ 1 acre
 ☐ 10 acres
 ☐ 20 acres

ACREAGE GUIDE

Other information including a narrative report concerning the wetland resources depicted on this document may be available. For information, contact:

**Regional Director (ARDE) Region II
U.S. Fish and Wildlife Service
P.O. Box 1306
Albuquerque, New Mexico 87103**

SPECIAL NOTE

SPECIAL NOTE

This document was prepared primarily by stereoscopic analysis of high altitude aerial photographs. Wetlands were identified on the photographs based upon vegetation, visible hydrology, and geography in accordance with **Classification of Wetlands and Deepwater Habitats of the United States** (FWS-79/31 December 1979). The aerial photographs typically reflect conditions during the specific year and season when they were taken. In addition, there is a margin of error inherent in the use of the aerial photographs. Thus, a detailed on the ground and historical analysis of a single site may result in a revision of the interpretation. In addition, some small wetlands and those obscured by dense forest cover may not be included on this document.

This document
Federal, State and local regulatory agencies with jurisdiction
over wetlands may define and describe wetlands in a
different manner than that used in this inventory. There is
no attempt, in either the design or products of this inventory,
to define the limits of proprietary jurisdiction of any
Federal, State or local government or to establish the
geographical scope of the regulatory programs of government
agencies. **Persons intending to engage in activities
involving modifications within or adjacent to wetland
resources should consult the authority of appropriate Federal, State
or local agencies concerning specified agency regulated
programs and proprietary jurisdictions that may affect
such activities.**

SYMBOLGY EXAMPLE

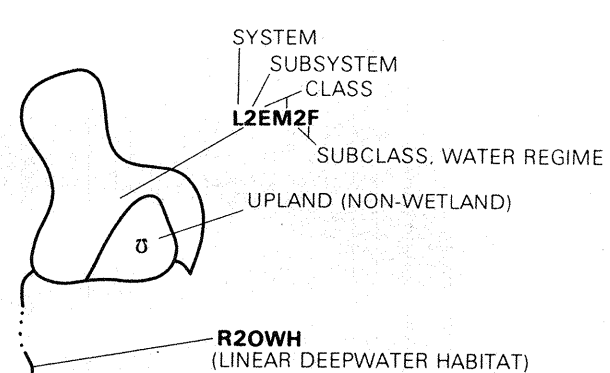

NOTES TO THE USER

- ## NOTES TO THE USER
- Wetlands which have been field examined are indicated on the map by the asterisk (*).
 - Additions or corrections to the wetlands information displayed on this map are solicited. Please forward such information to the address indicated.
 - Subsystems, Classes, Subclasses, and Water Regimes in *italics* were developed specifically for NATIONAL WETLANDS INVENTORY mappings.
 - Some areas designated as R4SB, R4SBW, OR R4SBJ (INTERMITTENT STREAMS) may not meet the definition of wetland.
 - This map uses the class Unconsolidated Shore (US).
 - On the NWI maps that class was designated Beach/Bar (BB), or Flat (FL). Subclasses remain the same in both versions.

AERIAL PHOTOGRAPHY

DATE: 9 / 81 DATE: / /
SCALE: 1:58 000 SCALE: / /
TYPE: CIR TYPE: /

ECOLOGICAL SERVICES
222 S. HOUSTON, SUITE A
TULSA, OK 74127

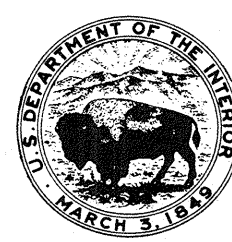

U.S. DEPARTMENT OF THE INTERIOR
FISH AND WILDLIFE SERVICE
Prepared by National Wetlands Inventory

1989